



LEHiSA[®]

BRASS PRECISION TURNING

COMPANY

PRODUCTION

QUALITY AND ENVIRONMENT

SERVICES

MACHINERY

[TIMELINE](#) | [ABOUT US](#) | [MISSION VISION AND VALUES](#) | [OUR TEAM](#)

Our Company

Flexible, precise, reliable custom-made **according to your specification**



We guarantee **quality and care** for nature



Over **35 years** of experience



Production of **small and medium runs**

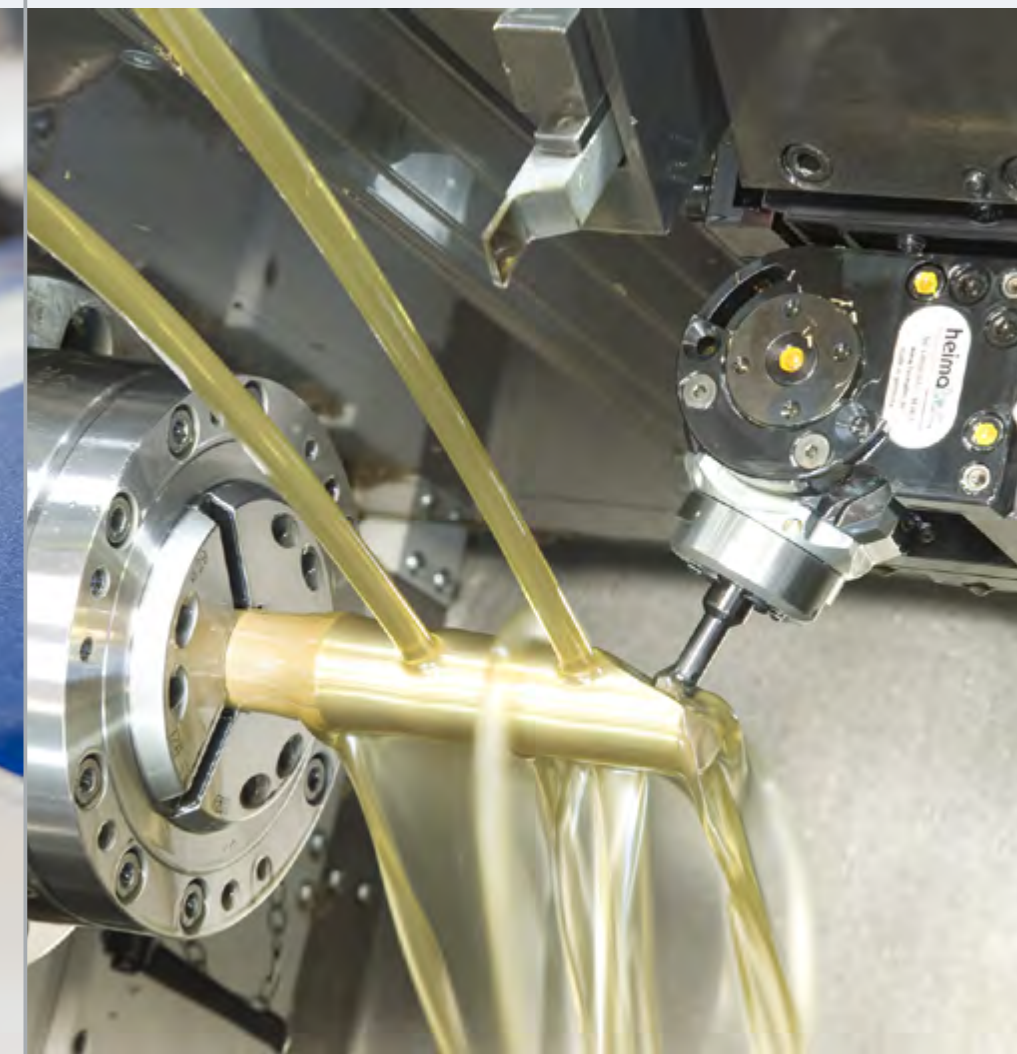

Production of **very large runs**



35 Successful years

1983

Lehisa was founded.

1987

Move to the new company-owned building. Company concentrates on exclusively manufacture turned parts in brass alloys. Purchase of the first multi-spindle machine for large-scale production series (Wickman 1"-6). First international customers in France.

1994

Company is expanded to a new location with an extension to the production plant, total 1.000 m². Installation of an automatic centrifuge machine and chip conveyor system with silo.

1999

Business expanded and moved to bigger factory of approximately 2.000 m². Followed by extensive changes in the machine park. Acquisition of the first CNC lathe machine.

2001

The company's quality management system is certified by BVQI Cert in accordance with EN ISO 9001 for the first time. Workforce exceeds 25 for the first time.

2008

The company celebrates its 25th anniversary.

2009

First appearance as exhibitor at a foreign trade fair, Midest, Paris. Entrance in new markets as medical engineering.

2010

Successful exhibitor at Hannover trade fair.

2012

Establishment of in-house tool manufacturing department.

2014

Acquired an automatic bending machine for the manufacture of brass elbows for water hoses producers.

2015

Increase of the warehouse capacity by 500 m², with a total of 2.500 m².

2016

Acquisition of the first two 8/32 Mori Say multispindle machines.

2017

Lehisa runs a social project for the first time.

2019

Certifications according to ISO / TS 16949:2002

Acquisition of a DuraMax 3D coordinate measuring machine for the direct measurement of complex parts during production.

COMPANY

PRODUCTION

QUALITY AND ENVIRONMENT

SERVICES

MACHINERY

[TIMELINE](#) | [ABOUT US](#) | [MISSION VISION AND VALUES](#) | [OUR TEAM](#)

About our Company



2500m²



30 Employees

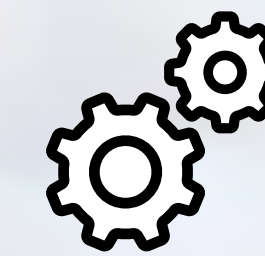

40 Machines

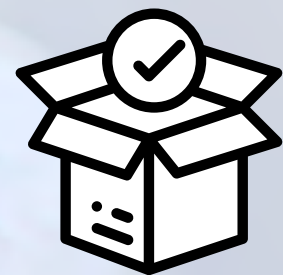

2000 Metric Tones

30

Million parts



10 Export countries

LEHISA
BRASS PRECISION TURNING

Mission

Our mission is to become **one of the leading company** in the European brass turning parts sector.

We are committed to **investing in our people, our company and our customers** to help position the company for long term, sustainable growth.

Vision

At Lehisa, **we aim to deliver top-tier financial performance** over the long term.

By integrating sustainability into our business strategy leaving a positive imprint on society and the environment.

Values



Customer

We work to know **the needs and expectations of our customers** in order to offer them better solutions.



Dignity & Respect

We treat all individuals with **dignity and respect**.



Quality & Safety

We create a safe environment **where quality is our guiding principle**.



Responsibility & Integrity

We perform our work **with the highest levels of responsibility and integrity**.



Environment

We respect the environment as **one of the principle pillars of our production model**.



Excellence & Innovation

We think **creatively and build excellence** into everything that we do.

COMPANY

PRODUCTION

QUALITY AND ENVIRONMENT

SERVICES

MACHINERY

[TIMELINE](#) | [ABOUT US](#) | [MISSION VISION AND VALUES](#) | [OUR TEAM](#)

Meet our team



Francisco León

Founder and CEO



Javier León

General Director



Rosa León

Finance & Accounting Manager
and Human Resources



Lidia Sánchez

Logistics Manager



Ignacio Guerrero

Quality Manager



Turned and chuck parts

Precision turned parts

We manufacture precision turned parts in **small, medium and large production** runs for all branches of industry. The ranges of producible dimensions are as follows:

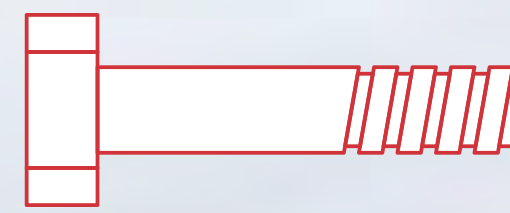

LONG TURNED PARTS

Ø 3 - 38 mm
Length up to 1200 mm

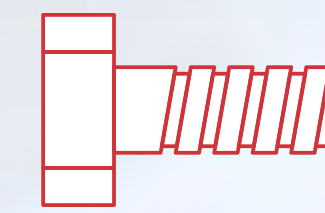

SHORT TURNED PARTS

Ø 10 - 65 mm
Length up to 350 mm

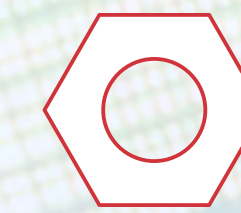

CHUCK PARTS

Up to Ø 250 mm

Materials

We manufacture complicated and simple turned parts from mainly from:

Copper alloys

- Brass: e.g. CW614N, CW617N, CW602N, CW612N, CW608N , CW625N, CW626N
- Low-lead brass: e.g. CW509L, CW510L, CW511L
- Lead-free brass: e.g. CW724R (Ecobrass)

Other materials on request

COMPANY

PRODUCTION

QUALITY AND ENVIRONMENT

SERVICES

MACHINERY

PRODUCTS GALLERY | SECTORS, TREATMENTS AND FINISHES

Our products



Brass Faucet Bodies



Brass Nuts



Brass Fittings



Copper Parts



Brass Screws



Chemical-Nickel Plated
Brass Fittings



Inox Fittings



Medical Components



Brass Hose Elbows

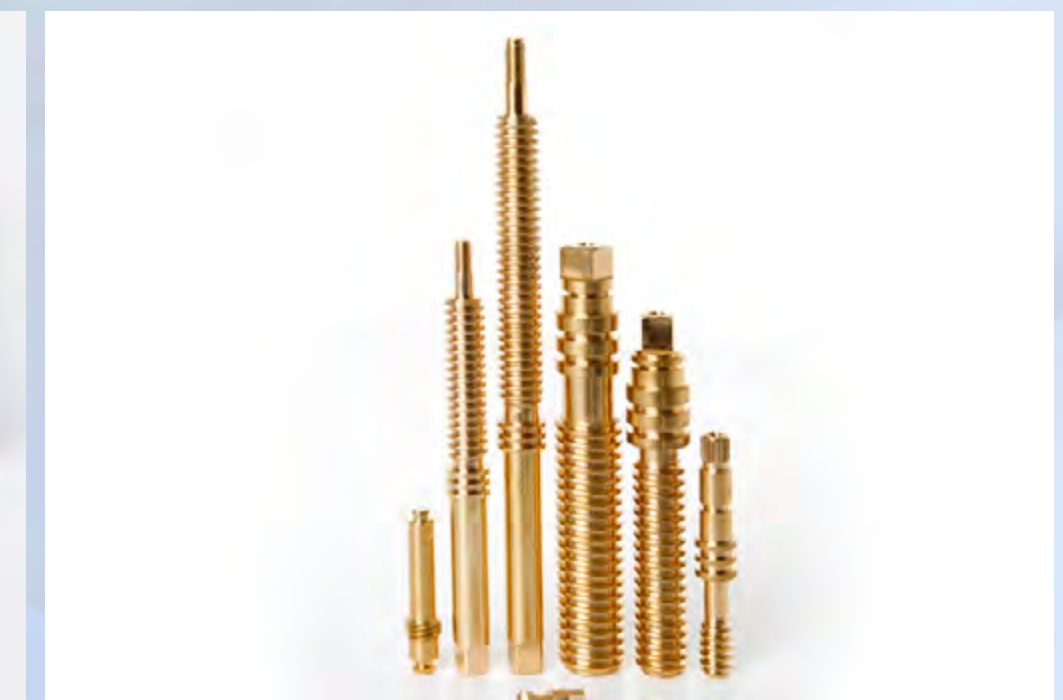

Brass Spindles

Sectors, Treatments & Finishes

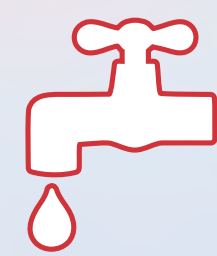

Sanitary
and fittings
industry

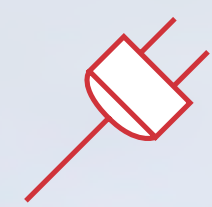

Electrical



Air conditioning
and refrigerator

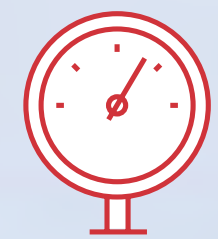

Control and
regulation
industry



Automotive

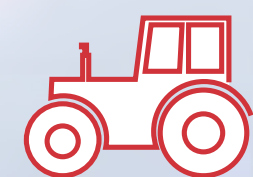

Agricultural



Medical

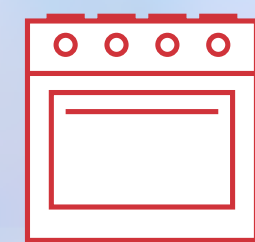

Domestic
equipment



Fire protection
system

Treatments and finishes

We offer **finishing and heat treatment** as part of our service.



Surface
Treatment

- Electroless nickel plating
- Chemical nickel plating
- Silver plating
- Black zinc
- Pickling



Heat
Treatment

- Stress relieving
- Annealing

Quality, Environment

Our commitment to the environment

We have long been aware of our responsibility towards the natural conditions for life, and by our actions **we create harmony between economy and ecology.**



Our quality management system is approved by certificate according to **ISO 9001:2015** since 2001

CSR

(Corporate Social Responsibility)



At **Lehisa** we believe our corporate social responsibility to be part of our general strategy, with the objective and the commitment to improve the well-being of the societies in which we are present.

In this regard, **Lehisa** has become one of the corporate partners of the Josep Carreras Leukaemia Research Institute.

What can we offer you

Engineering

Our team can advise you on the best material and process for your application.

Packaging and labelling

Our parts are packed and delivered free of grease and oil and:

- **Delivery in reusable packaging or customer-owned packaging**, as bulk goods or standing parts,
- **VDA-standard labelling**,
- **EDI** – Electronic Data Interchange

Delivery / Supply Chain

As part of our delivery and supply chain service, we provide when required:

- **Blanket orders** with call offs.
- **Consignment stock** with maximum and minimum quantity levels. We also offer consignment stock that can be held either at the customer facility or at Lehis, to maximise the customer's floor space.

Logistics

Our own fleet for local transport ensures fast and safe delivery of the finished products. For long distances or larger volumes, we are in constant contact with various transport companies.



COMPANY

PRODUCTION

QUALITY AND ENVIRONMENT

SERVICES

MACHINERY



Multi-spindle turning

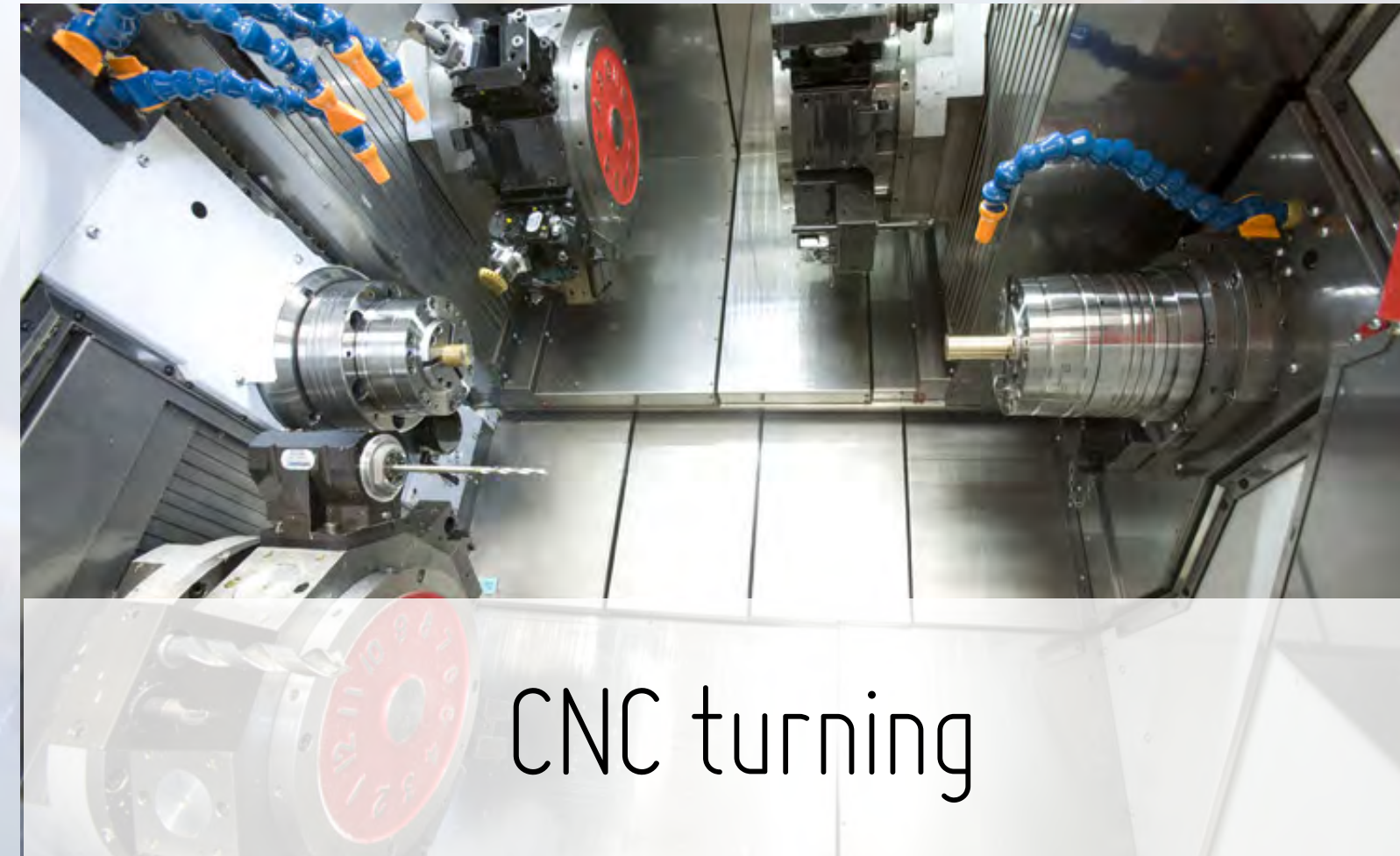

CNC turning



Cleaning machine



Bending Machine

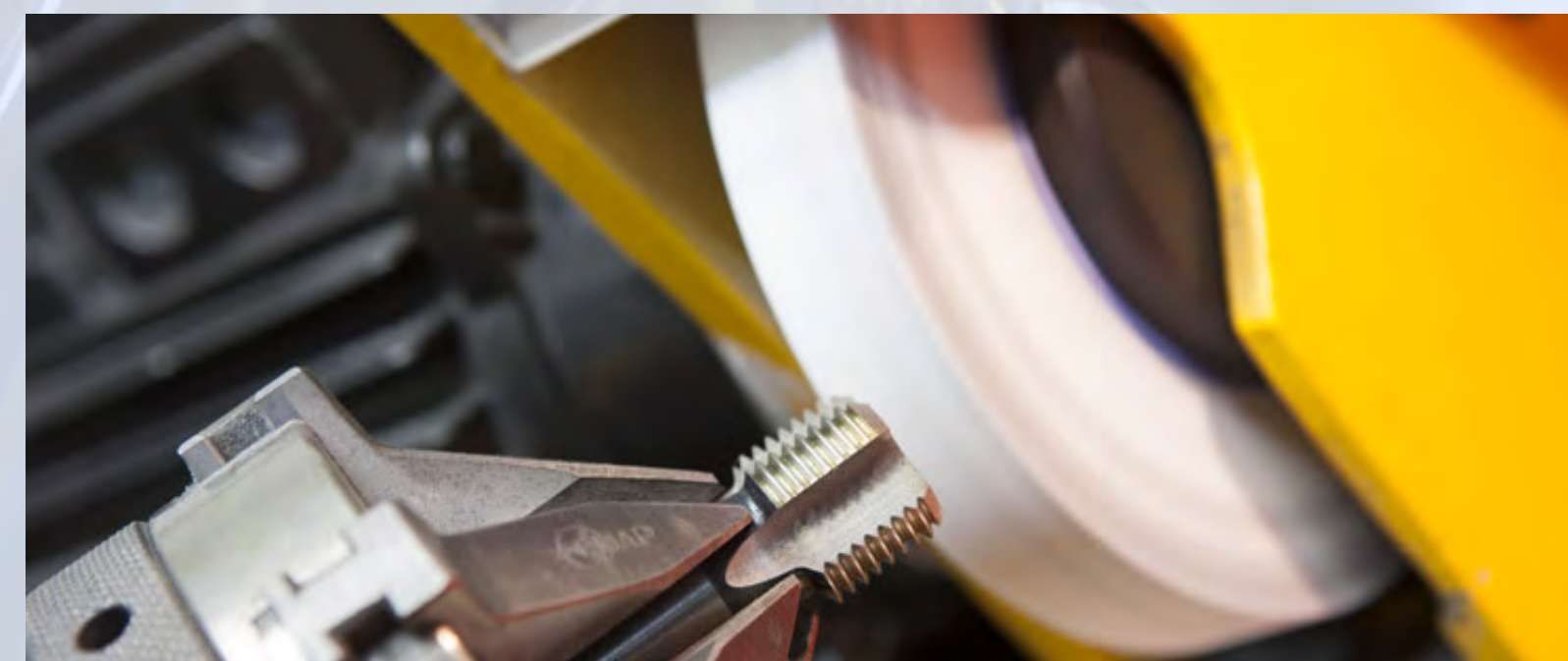

Tool grinding shop

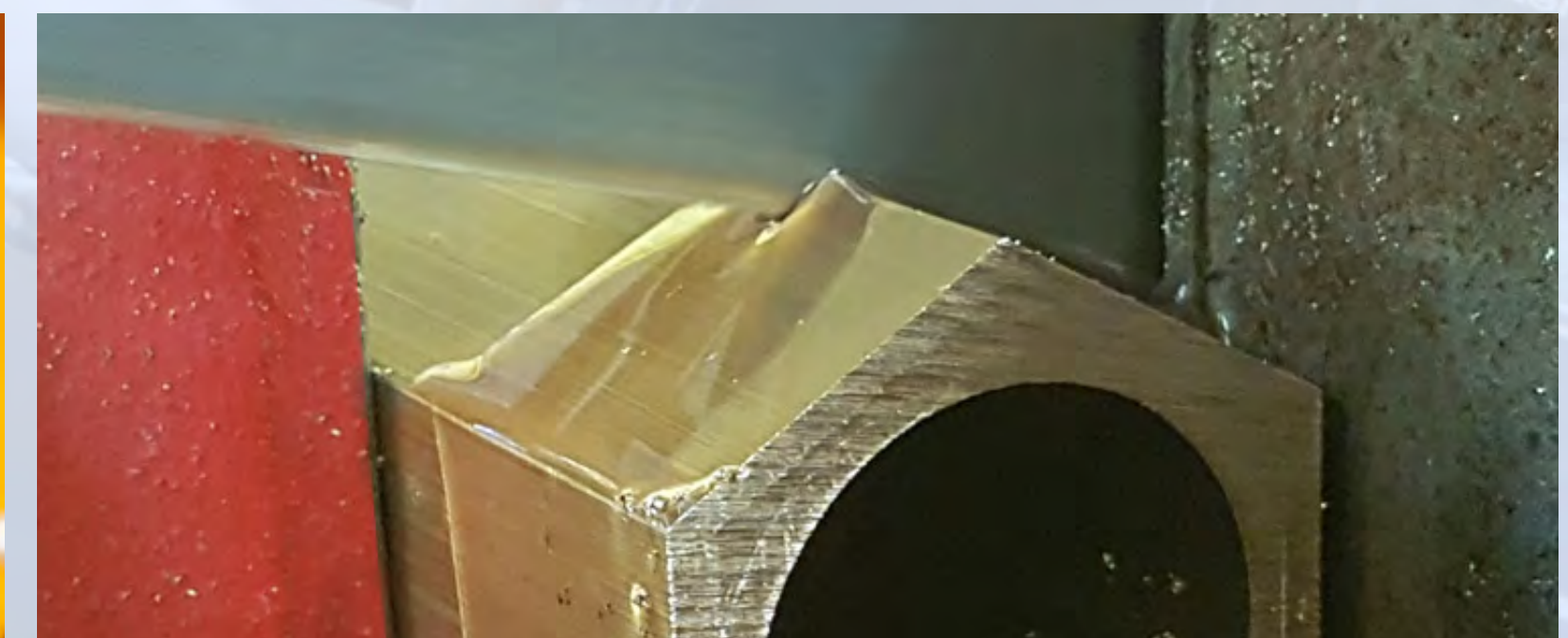

CNC Saw

[MULTI SPINDLE TURNING](#) | [CNC TURNING](#) | [CLEANING MACHINE](#) | [BENDING MACHINE](#) | [TOOL GRINDING SHOP](#) | [CNC SAW](#)



Multi-Spindle Turning

We have 21 multi-spindle machines on which we produce medium and large-scale orders. The diameter ranges from diameter 6 to 46 mm.

- 12 Wickman 1"-6
- 1 Wickman 1 3/8"-6
- 1 Gildemeister GM42
- 1 Mori-Say 6/32
- 2 Mori-Say 6/25
- 2 Mori-Say 8/32
- 1 Gildemesiter AS16
- 1 Gildemesiter GS20
- 1 Tornos SAS 16.6

All multi-spindles machines are equipped with automatic bar loaders.

[MULTI SPINDLE TURNING](#) | [CNC TURNING](#) | [CLEANING MACHINE](#) | [BENDING MACHINE](#) | [TOOL GRINDING SHOP](#) | [CNC SAW](#)

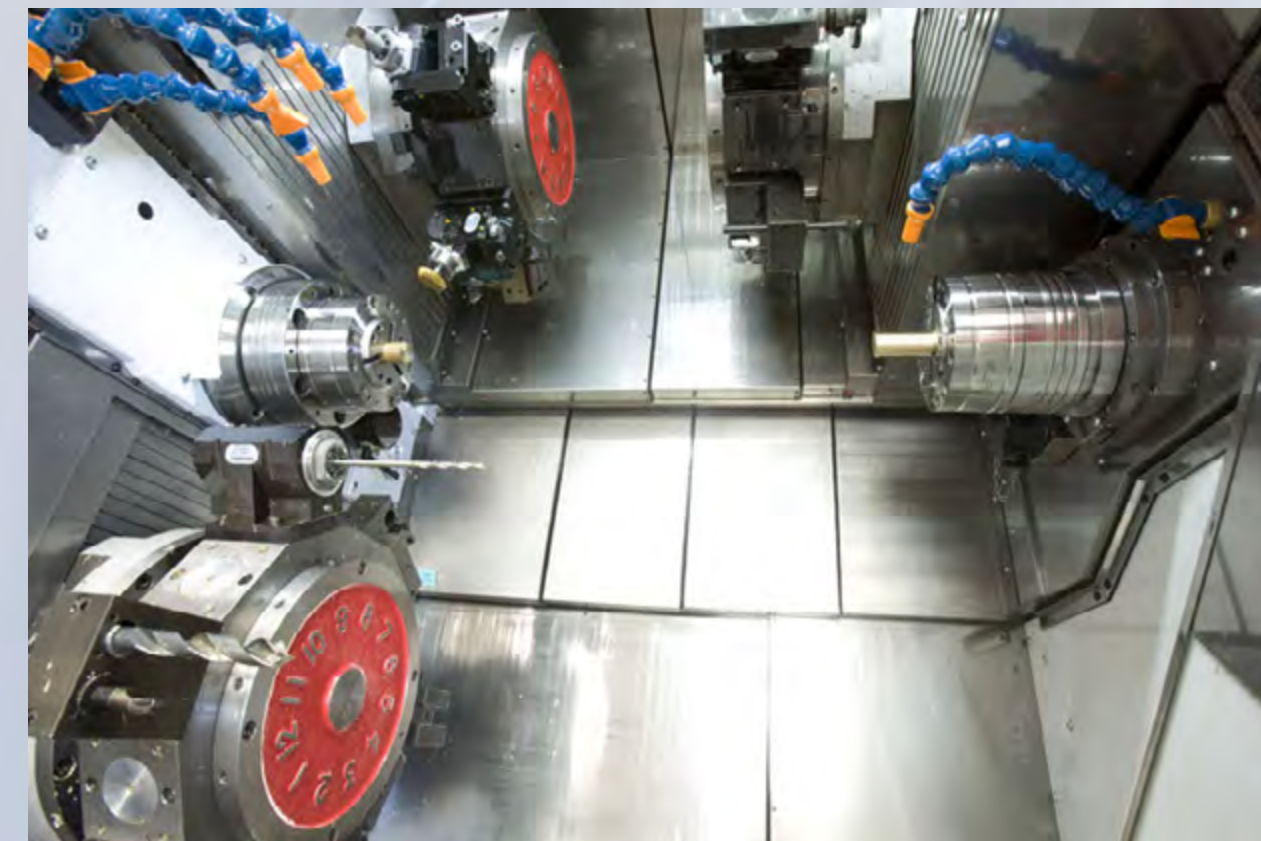
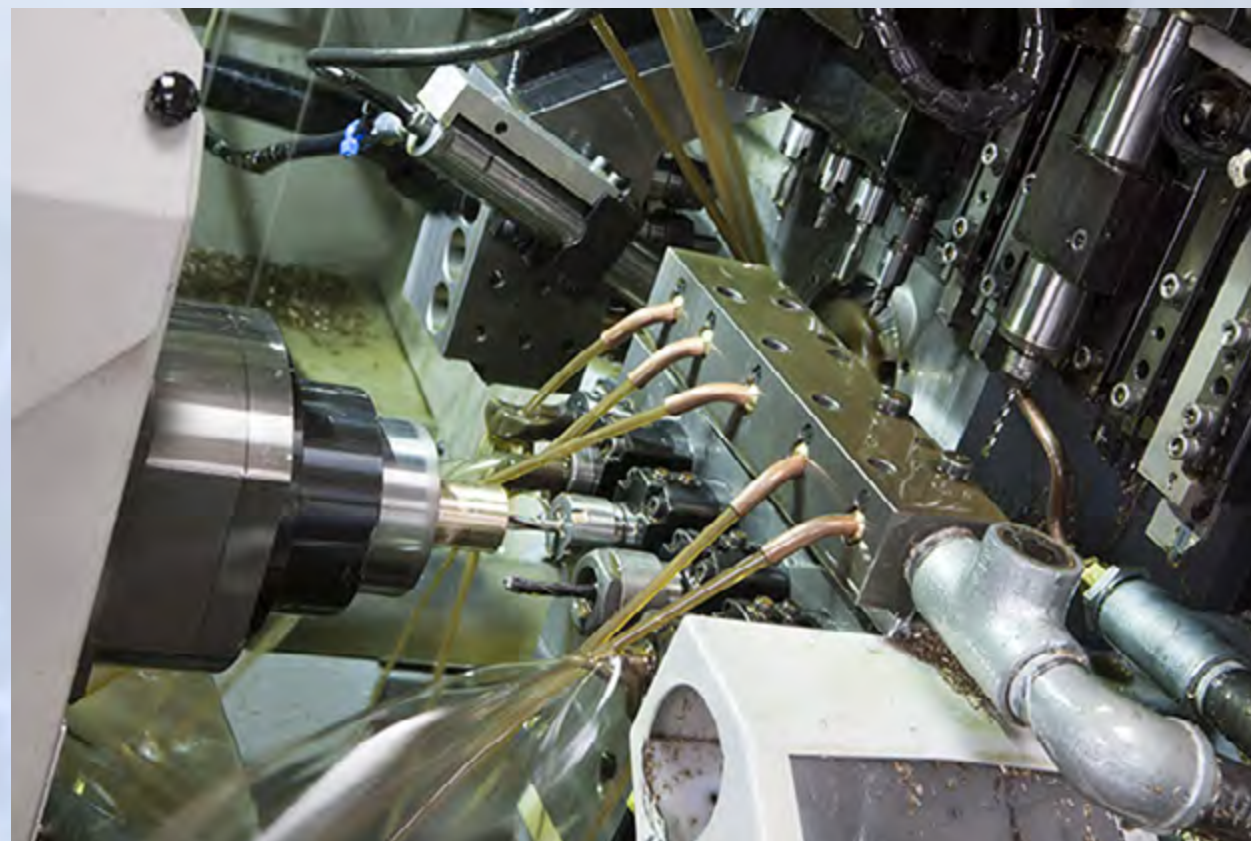
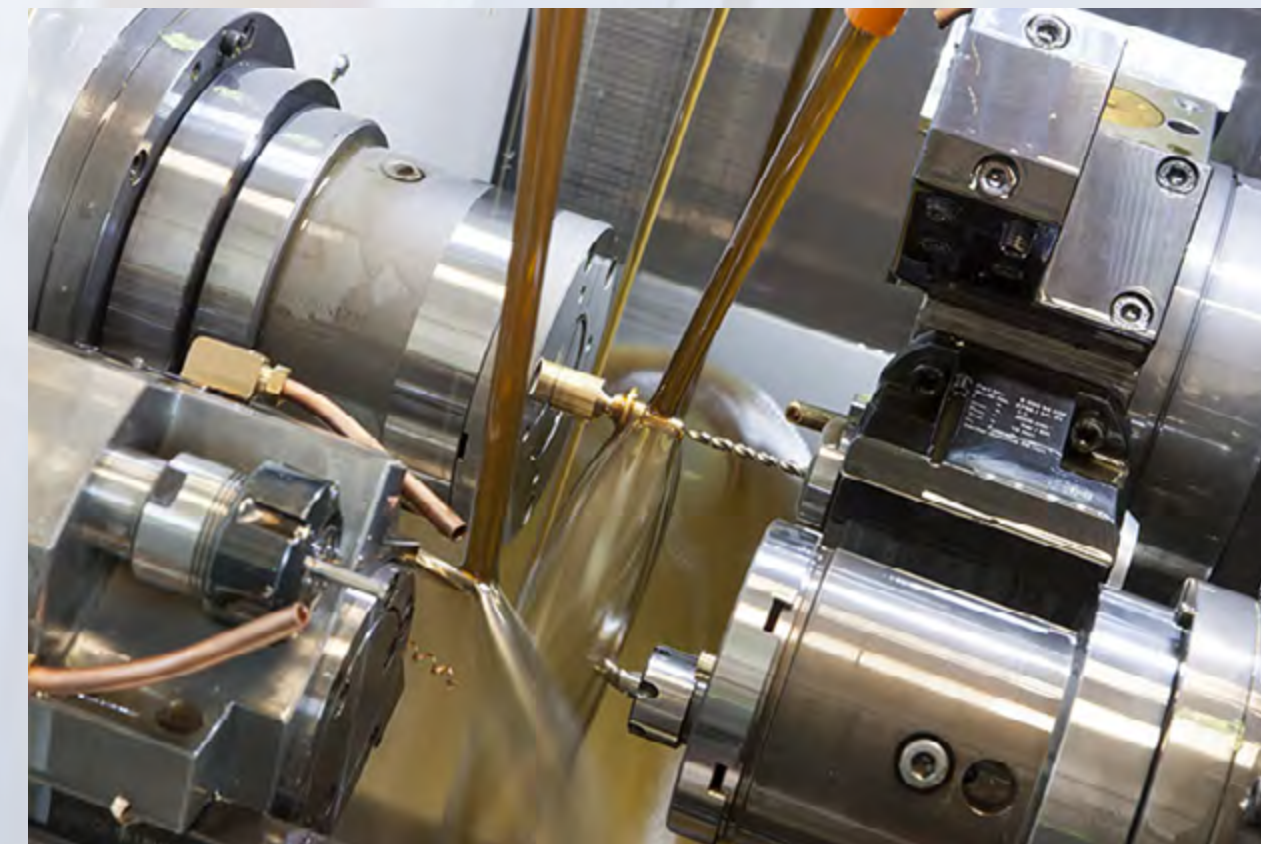
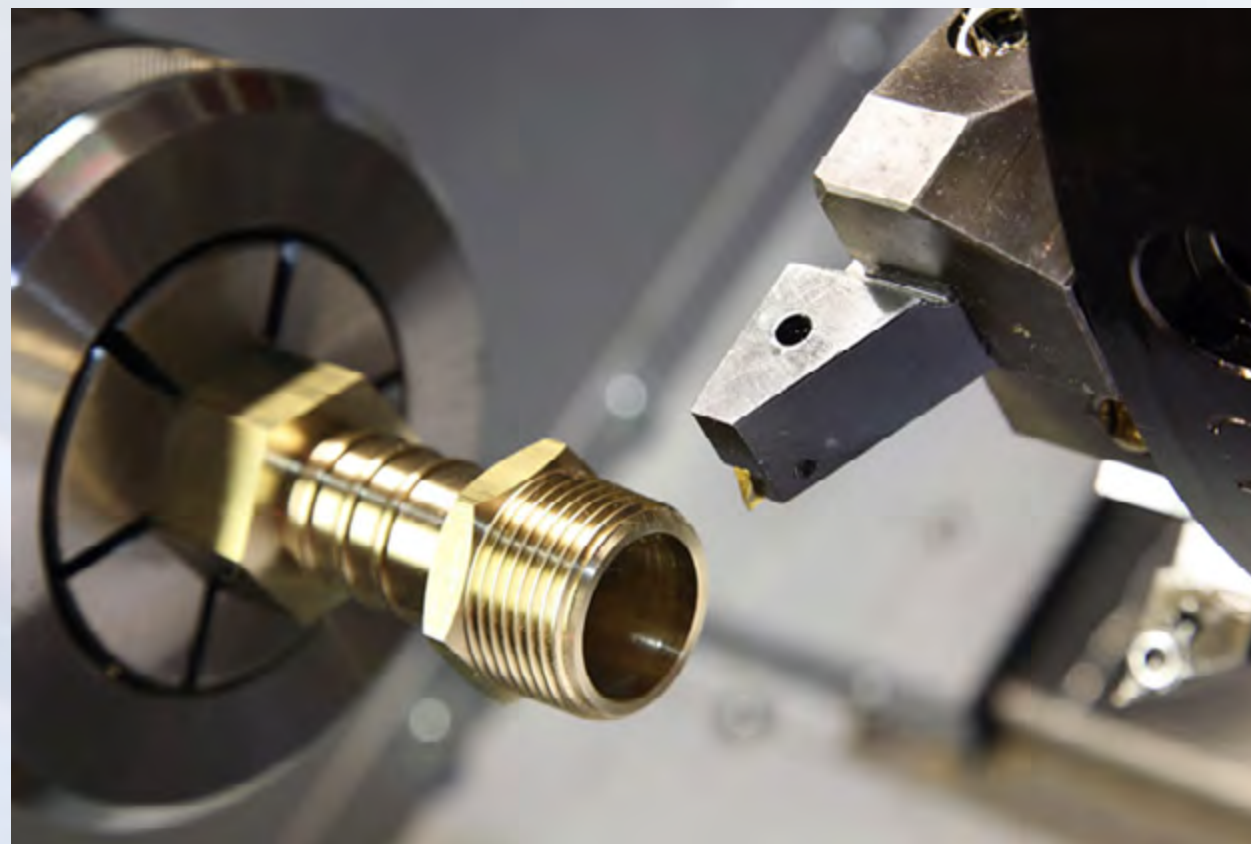

CNC turning

We have 15 most modern CNC machines on which we produce turned parts ranging from Ø 4 to Ø 65 mm bar and chuck type machining up to Ø 250 mm. With these machines we have a high flexibility producing difficult parts in low and high volumes.

CNC Fixed Head lathes

Complex turned parts up to Ø 65 mm.
Twin spindle and two turrets machine

- 2 Miyano BNA-42DHY
- 3 Miyano BNJ-42SY
- 1 Miyano BNJ-42SY3
- 1 Miyano BNJ-42SY6
- 1 Miyano ABX-64SYY2

Twin spindle and three turrets machine

- 1 Miyano ABX-64THY
- 1 Miyano ABX-64THY2

CNC Sliding Head lathes Ideal for
long turned parts from Ø 3 mm up to
Ø 32 mm and 200 mm length.

- 1 Citizen K16-VII
- 1 Citizen L20-VIII
- 2 Citizen M32-III
- 1 Citizen A32-VII

COMPANY

PRODUCTION

QUALITY AND ENVIRONMENT

SERVICES

MACHINERY

[MULTI SPINDLE TURNING](#) | [CNC TURNING](#) | [CLEANING MACHINE](#) | [BENDING MACHINE](#) | [TOOL GRINDING SHOP](#) | [CNC SAW](#)



Cleaning machine

Clean and degrease equipment with perchloroethylene (to avoid trichloroethylene) under a closed full-vacuum system and zero atmospheric emission.

COMPANY

PRODUCTION

QUALITY AND ENVIRONMENT

SERVICES

MACHINERY

[MULTI SPINDLE TURNING](#) | [CNC TURNING](#) | [CLEANING MACHINE](#) | [BENDING MACHINE](#) | [TOOL GRINDING SHOP](#) | [CNC SAW](#)



Bending Machine

Tube bending machine for brass tubes up to 24 mm in diameter. Its integrated loading-unloading enable automated non-stop operation.

COMPANY

PRODUCTION

QUALITY AND ENVIRONMENT

SERVICES

MACHINERY

MULTI SPINDLE TURNING | CNC TURNING | CLEANING MACHINE | BENDING MACHINE | TOOL GRINDING SHOP | CNC SAW



Tool grinding shop

We are totally self-sufficient in all aspects of tooling, enabling rapid response to all our shop floor and customer requirements.

- Wire EDM machine
- Grinding machines
- CAD-CAM capabilities

COMPANY

PRODUCTION

QUALITY AND ENVIRONMENT

SERVICES

MACHINERY

[MULTI SPINDLE TURNING](#) | [CNC TURNING](#) | [CLEANING MACHINE](#) | [BENDING MACHINE](#) | [TOOL GRINDING SHOP](#) | [CNC SAW](#)

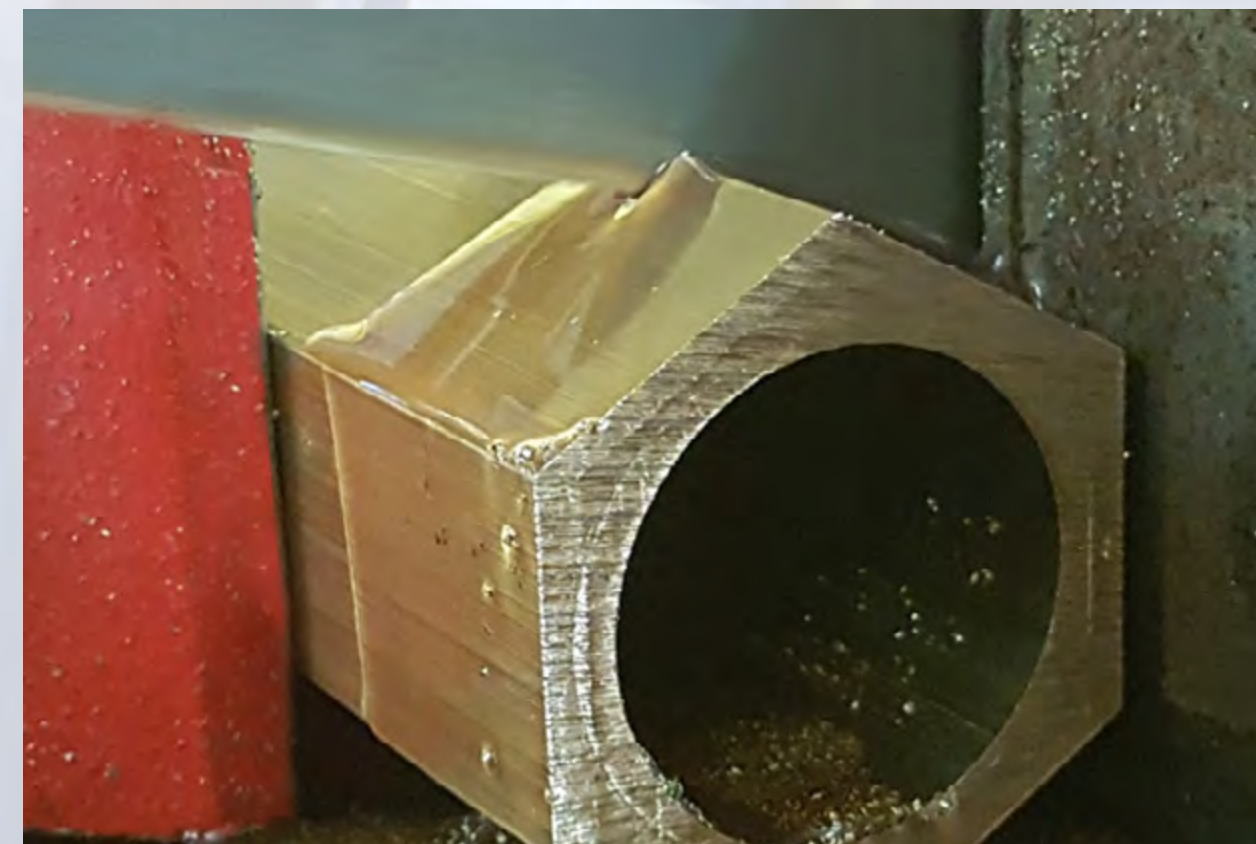

CNC Saw

Automatic band saw, brand FAT model 350A with CNC and automatic feeder. Ideally suited for the productions of accurately cut parts for CNC lathes. Maximum cutting capacity 250 mm.



COMPANY

PRODUCTION

QUALITY AND ENVIRONMENT

SERVICES

MACHINERY



BRASS PRECISION TURNING

LERRASA HIDRÁULICA, S.A.

C/ Balmes, 14 • 08291, Ripollet • Barcelona - España
Phone +34 936 928 202 • lehisa@lehisa.com

www.lehisa.com



BLOG

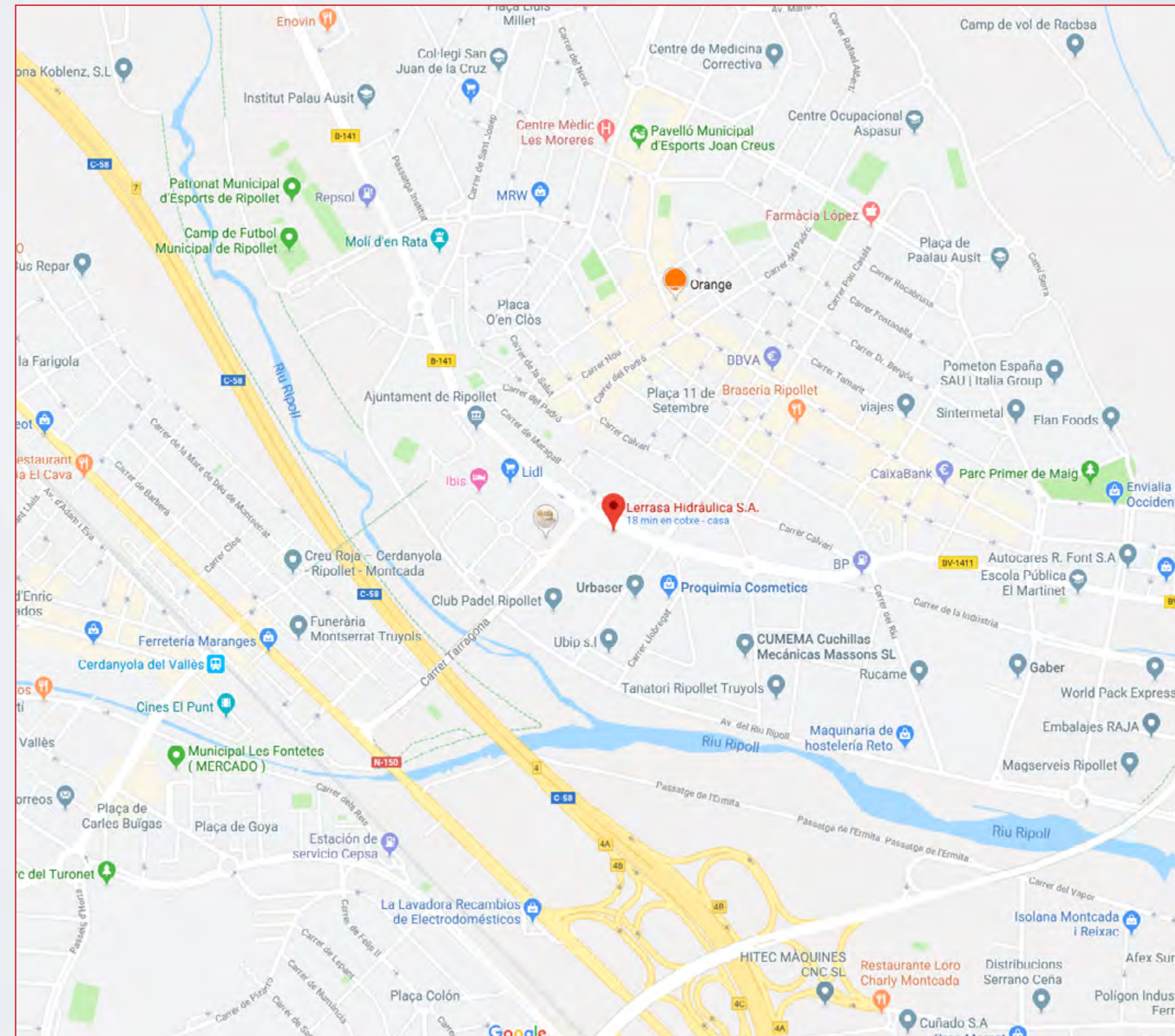

X | CLOSE



PRODUCTS GALLERY

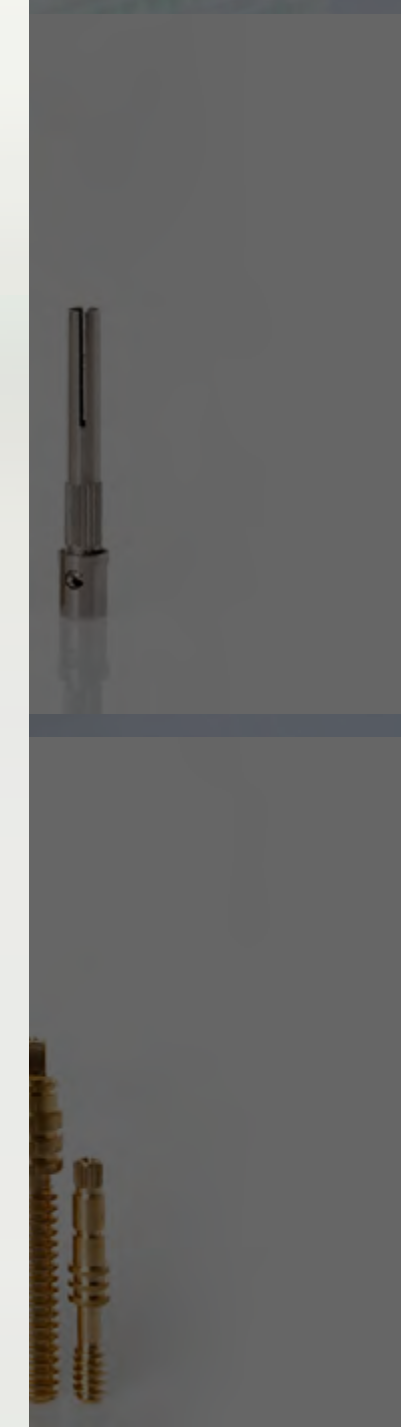
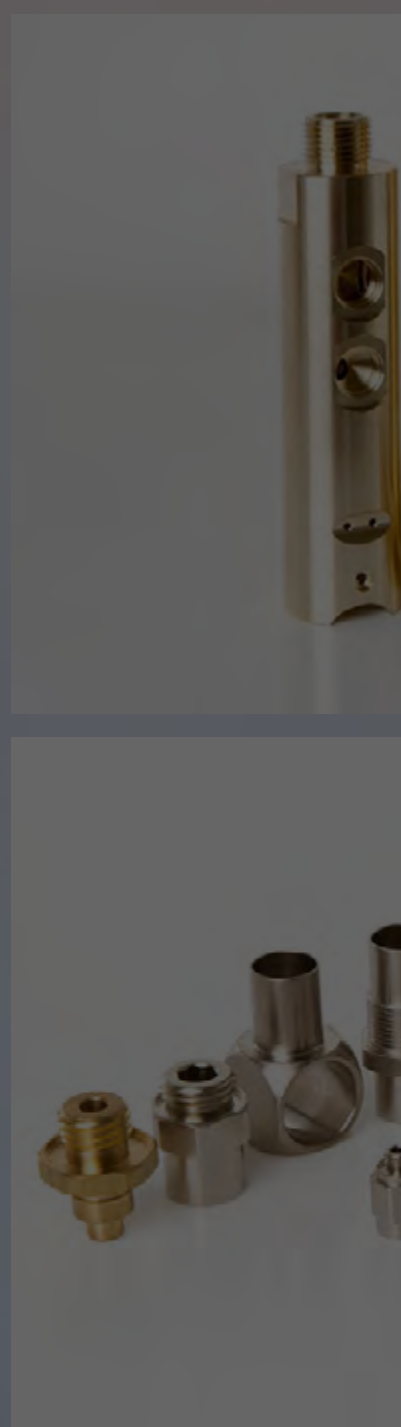

✕ | CLOSE



PRODUCTS GALLERY

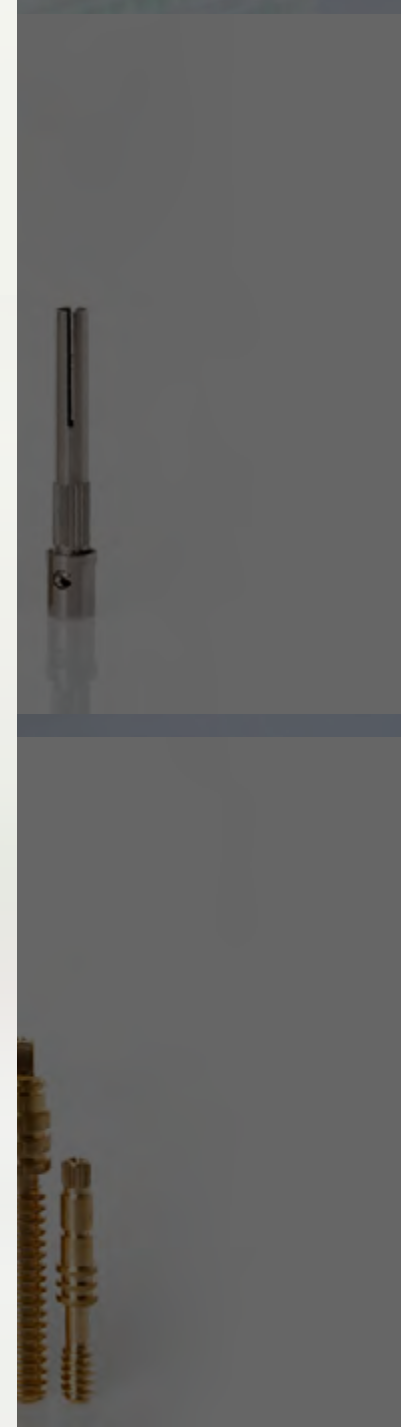
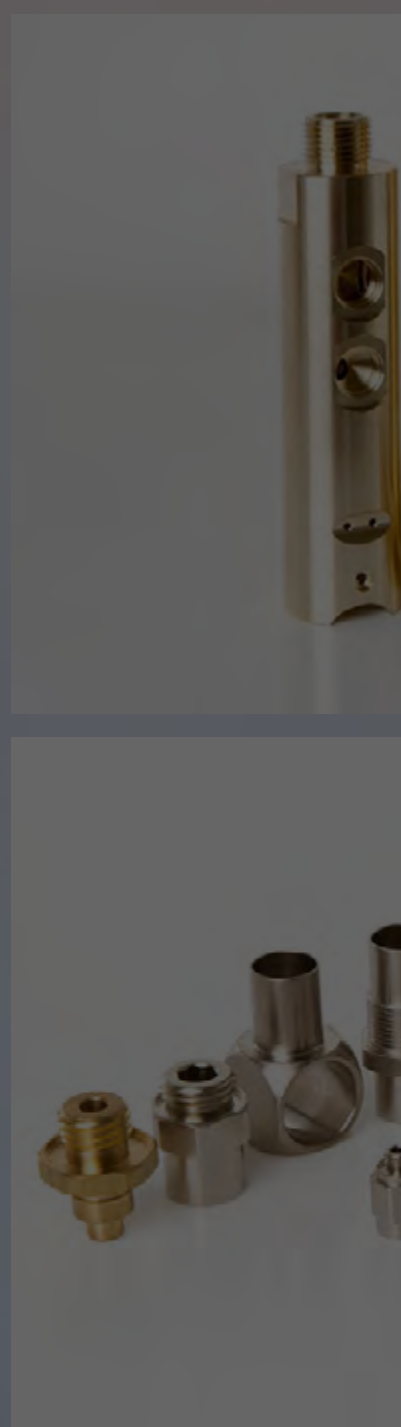

✕ | CLOSE



PRODUCTS GALLERY

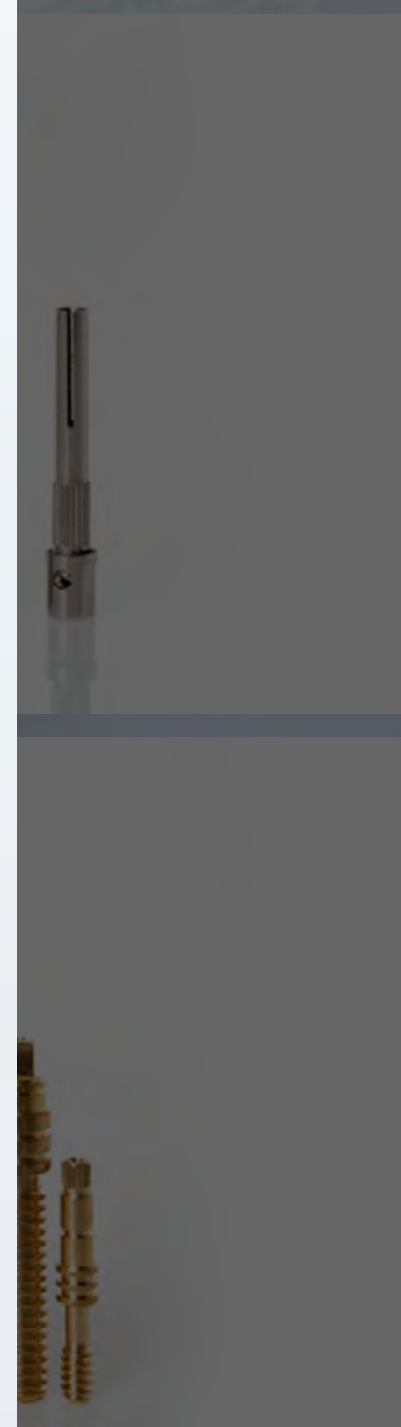
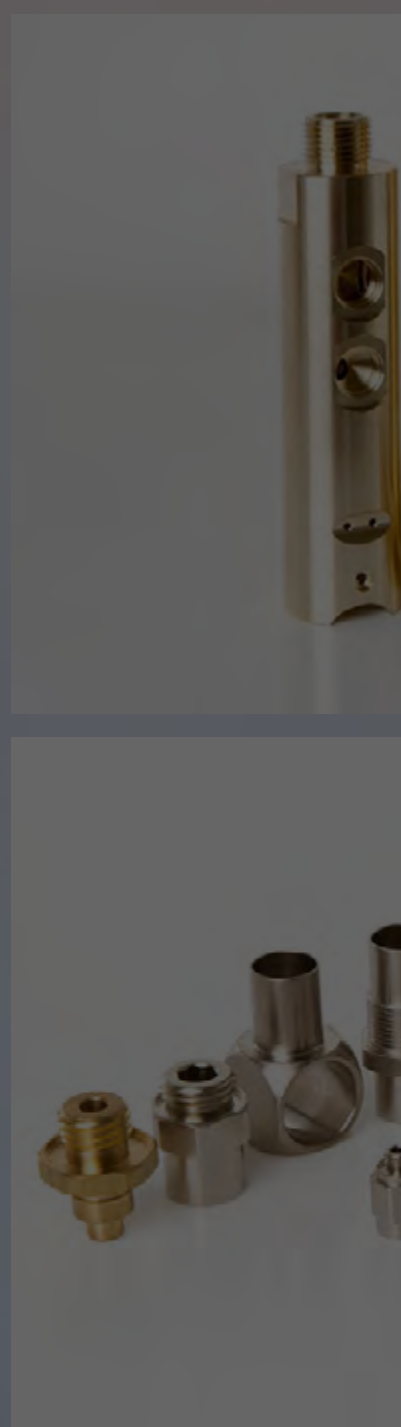

X | CLOSE



PRODUCTS GALLERY

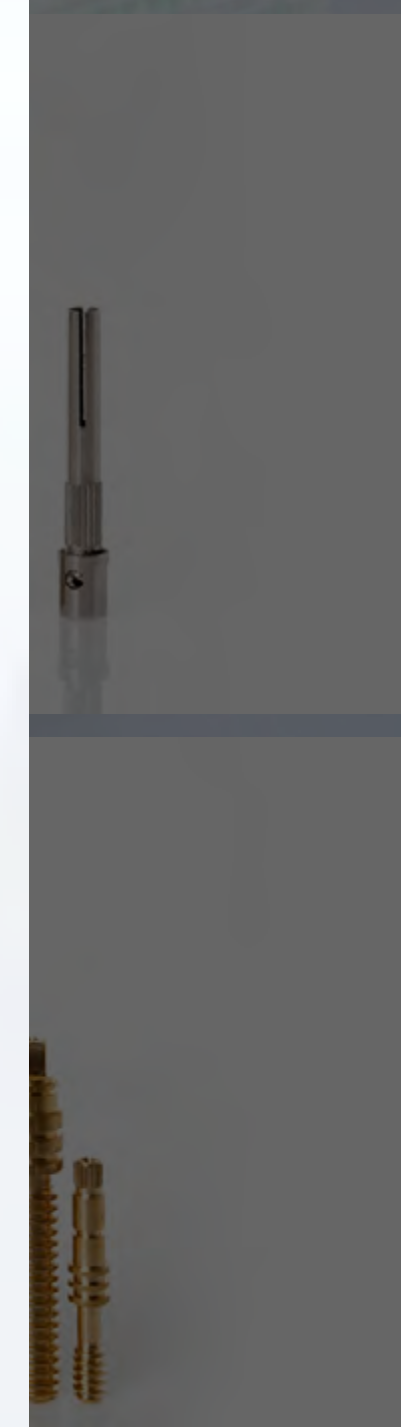
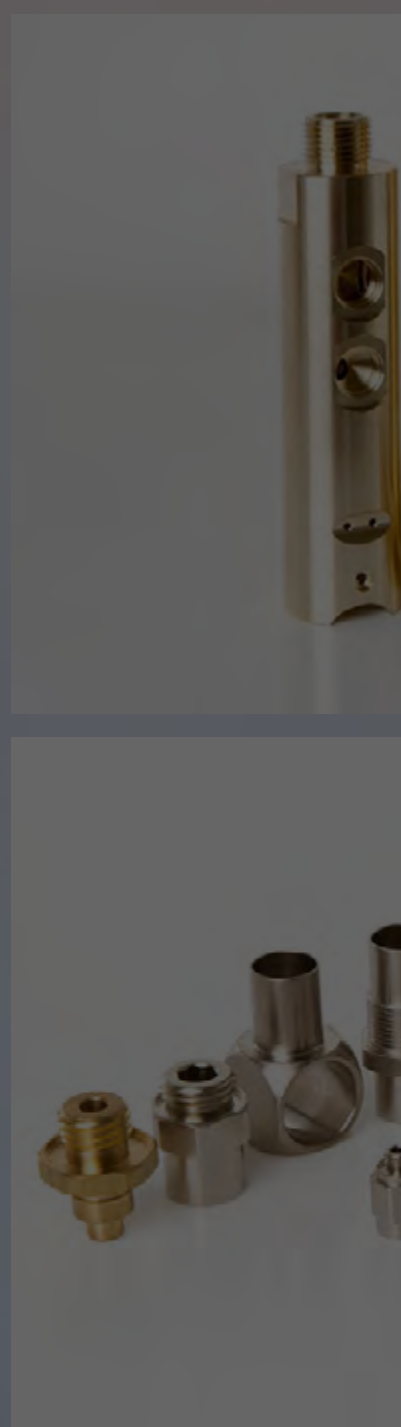

X | CLOSE



PRODUCTS GALLERY



PRODUCTS GALLERY



X | CLOSE



PRODUCTS GALLERY

X | CLOSE



PRODUCTS GALLERY

X | CLOSE



PRODUCTS GALLERY

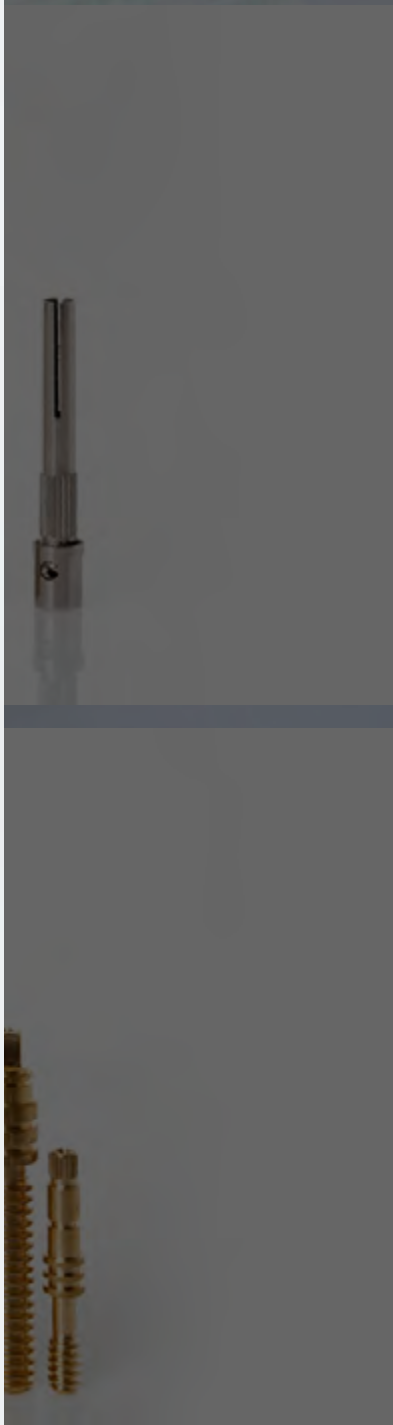

X | CLOSE



PRODUCTS GALLERY

